

SAFE-T-LIP (2-3-2) ASSEMBLY PARTS

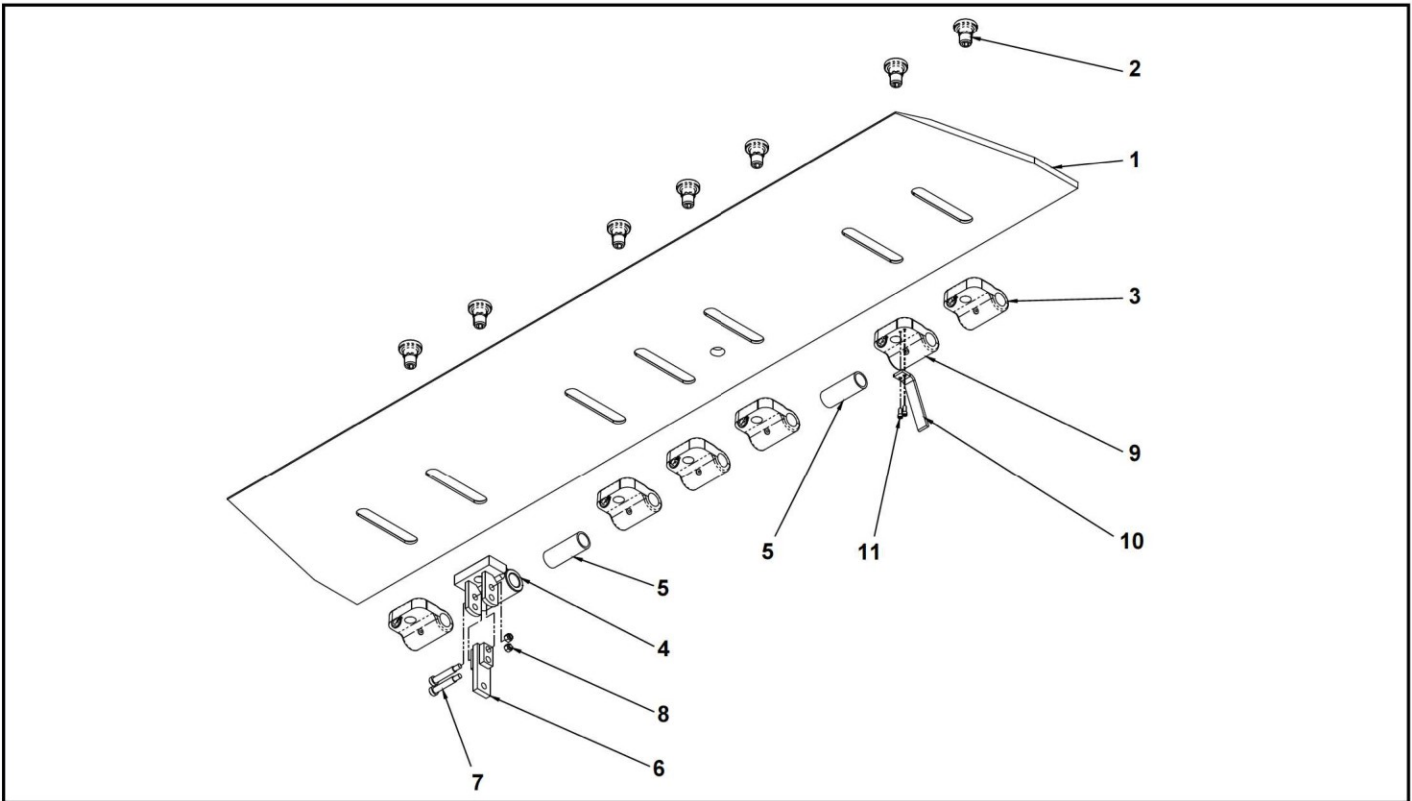

Item	Qty.	Description	RHA40
1	1	Safe-T-Lip Plate Square Ends Tapered Ends (Shown) Notched Ends	See Descriptions 684.XXX 685.XXX 686.XXX
2	7	Shoulder Bolt - 1.125Dia	129099
3	5	Lip Spool Module (Cast Standard) 3/8" Header, 5/8" - 11/16" Lip 3/8" Header, 3/4" Lip 1/2" Header, 5/8" - 11/16" Lip 1/2" Header, 3/4" Lip	See Descriptions 140484 140485 140486 140487
4	1	Lip Spool Module - Lip Lug Assembly 3/8" Header, 5/8" - 11/16" Lip 3/8" Header, 3/4" Lip 1/2" Header, 5/8" - 11/16" Lip 1/2" Header, 3/4" Lip	See Descriptions 129226 129227 129228 129229
5	2	Tube 1-1/2 OD X 3-7/8 Long	477d100
6	1	Lip Lug Weldment RHA	129255
7	2	Shoulder Bolt .375-16 X 2.875	129258
8	2	Nut .375-16 Nylock ZP	51501
9	1	Lip Spool Module (ARTD Option)	See Descriptions
		3/8" Header, 5/8" - 11/16" Lip	148056
		3/8" Header, 3/4" Lip	148057
		1/2" Header, 5/8" - 11/16" Lip	148058
		1/2" Header, 3/4" Lip	148059
10	1	ARTD Trigger (Safe-T-Lip) - Bolt on	129154
11	2	ARTD Trigger Mount bolts	118182